

# COLUMN COMPONENTS

## COLUMN PACKING-RASCHIG RINGS

Raschig ring ranging from 8 mm to 50 mm are available in 3.3. Borosilicate glass.



Cat. Ref.	Size	Bulk Density Kg/Ltr	Specific Surface m <sup>2</sup> /m <sup>3</sup>	Glass
FCB8	8x8	0.66	633	Borosilicate
FCB10	10x10	0.52	487	Borosilicate
FCB12	12x12	0.48	425	Borosilicate
FCB15	15x15	0.43	330	Borosilicate
FCB20	20x20	0.30	300	Borosilicate
FCB25	25x25	0.28	240	Borosilicate
FCB30	30x30	0.27	180	Borosilicate
FCB40	40x40	0.22	160	Borosilicate
FCB50	50x50	0.19	120	Borosilicate

## PALL RINGS

Pall Rings are also available for column packing as per below specification.

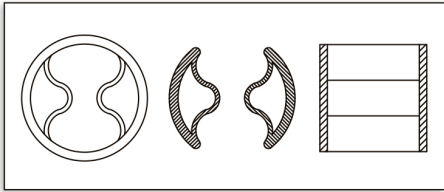

Cat. Ref.	Size	Bulk Density Kg/Ltr	Specific Surface m <sup>2</sup> /m <sup>3</sup>	Glass
FCP30	30x30	0.38	234	Borosilicate
FCP40	40x40	0.32	187	Borosilicate
FCP50	50x50	0.26	140	Borosilicate

## COLUMN FEED PIPE

Feed pipe directs the process fluid to the centre of the column.

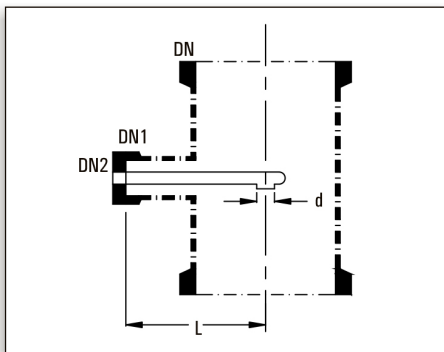

Cat. Ref.	DN	DN1	DN2	L	d
FP3	80	25	25	100	12
FP4	100	25	25	125	12
FP6	150	40	25	150	19
FP9	225	40	25	175	19
FP12	300	40	25	225	19
FP16	400	40	25	275	19
FP18	450	40	25	300	19
FP24	600	50	40	450	25

DN refers the nominal diameter of the column.

## COLUMN FEED SPARGERS

In column feed spargers, holes are provided at three sides of pipe.

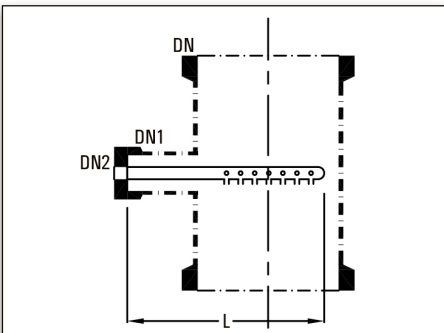

Cat. Ref.	DN	DN1	DN2	L	Holes
SPG3	80	25	25	125	21x2mm
SPG4	100	25	25	150	21x2mm
SPG6	150	40	25	200	27x2mm
SPG9	225	40	25	275	27x2mm
SPG12	300	40	25	350	30x3mm
SPG16	400	40	25	450	39x3mm
SPG18	450	40	25	500	39x3mm
SPG24	600	50	40	650	60x3mm

DN refers the nominal diameter of the column.